



# ANLY TIMER

ANLY

## ATS OFF DELAY TIMER



### CHARACTERISTIC :

- Off delay timer with adjustable time range
- Delay time up to 6M

### SPECIFICATION :

Operating voltage	DC(V): 24 AC(V): 24, 110, 220, 240
Allowable operating voltage range	85~110% of rated operating voltage
Rated frequency	50 / 60 Hz
Contact rating	250VAC 2A / 5A (resistive load)
Reset time	MAX 1S
Power consumption	Approx.3VA
Life	Mechanical: 5,000,000 times Electrical: 100,000 times
Ambient temperature	-10 ~ +50℃
Ambient humidity	MAX 85% RH
Weight	Approx. 140g

### TYPE SELECTION :

Type	ATS
Contact rating	250VAC 2A(1C)
Time range	3, 6, 10, 30, 60S 3, 6M

## CONNECTION :

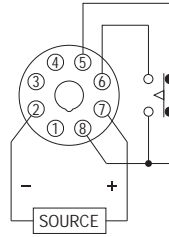

## TIMING CHART :

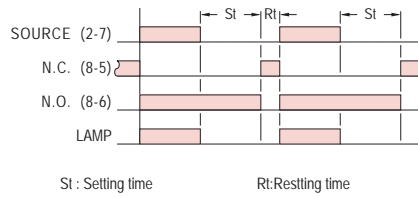

## DIMENSIONS : (mm)

N type(Surface Mounting): Using PF085A Socket & FH-3

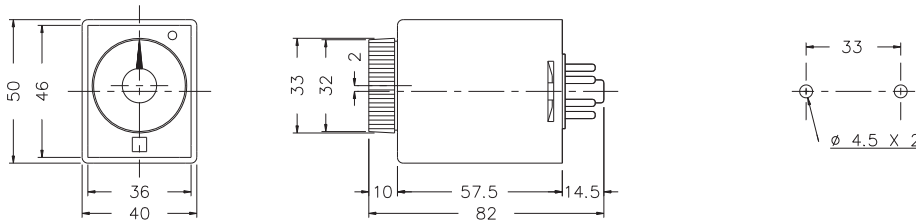

Y type(Flush Mounting): Using Y-40 Frame & US-08 Socket or P3G-08 Socket

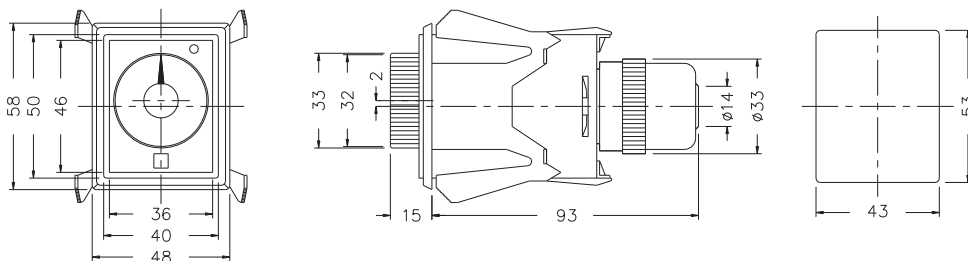

## ANLY ELECTRONICS CO., LTD.

<http://www.anly.com.tw>

### TAIWAN MAIN OFFICE : ANLY ELECTRONICS CO., LTD.

No.19, Lane 202, Fushou St., Xinzhuang Dist., New Taipei City 242, Taiwan  
TEL: +886-2-2996-3202 FAX: +886-2-2996-2017

### MALAYSIA BRANCH : JUSTY ELECTRONICS (M) SDN, BHD.

No.1, Jalan 6/89B, Kawasan Perindustrian Trisege, Batu 3 1/2 Off Jalan Sungei Besi, 57100 Kuala Lumpur, Malaysia  
TEL: +60-3-7983-5758 FAX: +60-3-7981-5052

### HONG KONG BRANCH : ANLY ELECTRONICS (HK) LTD.

Flat K, 13/F, Edward Mansion, 141 Prince Edward Road W., Kowloon, Hong Kong  
TEL: +852-2397-2505 FAX: +852-2397-6080

### SHANGHAI BRANCH : ANLY TECHNOLOGY (WUXI) CO., LTD.

Room 13G, No.831, Xinzha Rd., Jingan District, Shanghai, China 200041  
TEL: +86-21-6218-3300 FAX: +86-21-6217-5911